

## RedySmart® Series

## Compression Fittings with 50µ Filter

The fittings are delivered in pairs and must be mounted as follows: with filter at the inlet and without filter at the outlet.

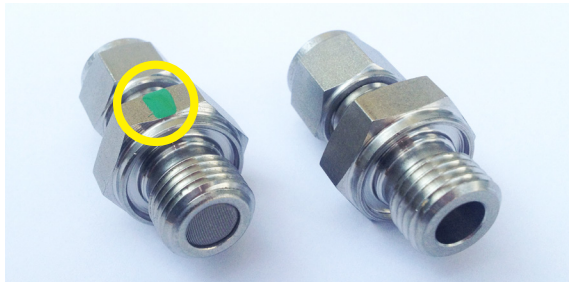

Fitting with filter  
(marked with one green dot)

Fitting without filter

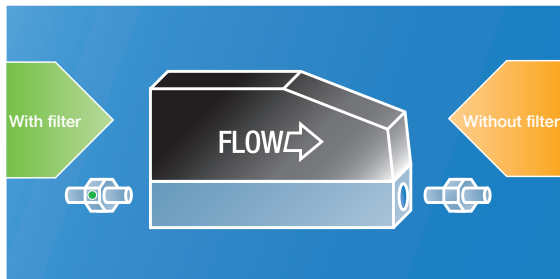

Mounting of the fittings

### Versions (stainless-steel 1.4404 / 316L)

#### Seals in FKM

328-1011  
328-1012  
328-1013  
328-1014  
328-1006  
328-1007

#### Seals EPDM

328-1031  
328-1032  
328-1033  
328-1034  
328-1026  
328-1027

#### Type/Connections

G 1/4" to 6mm  
G 1/4" to 1/4"  
G 1/4" to 12mm  
G 1/4" to 1/2"  
G 1/2" to 12mm  
G 1/2" to 1/2"

### Pressure loss (air)

#### Flow

5 l/min  
20 l/min  
40 l/min  
60 l/min

#### Pressure loss G 1/4"

2.2 mbar  
25 mbar  
85 mbar  
180mbar

#### Flow

50 l/min  
100 l/min  
200 l/min  
300 l/min  
400 l/min

#### Pressure loss G 1/2"

5 mbar  
10 mbar  
30 mbar  
70mbar  
140mbar

### Dimensions (mm)

#### Type

G 1/4" to 6mm  
G 1/4" to 1/4"  
G 1/4" to 12mm  
G 1/4" to 1/2"  
G 1/2" to 1/2"  
G 1/2" to 12mm

#### O

29  
29  
32.5  
32.5  
34.7  
36.7

#### P

19  
19  
21.5  
21.5  
21  
22.7

#### Wrench size

19  
19  
22  
22  
27  
27

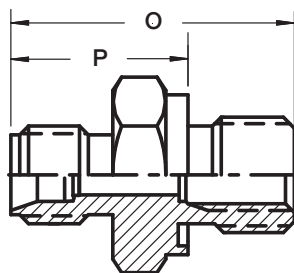

#### Dimensions (without connecting nut)

O = Overall length

P = Outside length after mounting

### Mounting

The fitting with filter must be mounted at the inlet (in the direction of the flow).

Do not injure the seals (O-rings) during mounting.

Please do not use liquid sealants or Teflon tape for sealing the threads.